

**WALTER SMITH (GOSBERTON) LIMITED  
TULL GRANGE  
CAWOOD LANE  
GOSBERTON  
SPALDING  
LINCOLNSHIRE  
PE11 4HB**

**INTERSTED PARTY REFERENCE NUMBER: ODOW – AFP125**

4th March, 2025

Planning Inspectorate,  
National Infrastructure Planning,  
Temple Quay House,  
2 The Square,  
BRISTOL. BS1 6PN

Dear Sirs,

**Ref Outer Dowsing Map 2.5 Land Plans V6  
Drawing No. PP1-ODOW-DEV-CS-MAP -0005-02    Drawing 46 of 51**

**SITE MEETING THURSDAY 13<sup>th</sup> February, 2025  
Gosberton Bank, Spalding, Lincolnshire.**

**Attendance:-**

**Tim & Cheryl Smith – Walter Smith (Gosberton) Ltd - Tenant  
Davina Fillingham – Land Owner  
Dan Jobe – Brown & Co  
Pippa Wright & Charlotte Brown - Dalcour Maclaren  
Jo Phillips - SLR Consulting Ltd. Landscape Architect  
Neil Whitehead – Land Drainage Services Ltd**

**Please refer to our letter dated 20.10.24 to yourselves.**

Following the site meeting above we feel it very necessary to write a report detailing the conversation at the above meeting and the continued concerns we have regarding the proposed 10 metre strip of landscaping on the Eastern boundary of our very fertile, grade 1 silt field.

- 1 The unnecessary destruction of grade 1 prime agricultural land which has grown – Broccoli, cauliflowers, cabbage, brussel sprouts, wheat, barley, sugar beet & potatoes.
- 2 The introduction of trees will cause a large increase in pigeons eating off the vegetables. Shadows being created over the growing crops causing poor stunted growth. Root growth into the field & field drainage system. The tree canopies will in time extend beyond the boundary fence and cause more land in the field to be unproductive.
- 3 No Farm should be asked to surrender a boundary ditch, in view of the weather conditions faced over the last 2 decades.

- 4 Long term maintenance - vegetation growth under the trees will lead to noxious weed seeds being blown across the field – most commonly docks, ragwort & thistles. Over a period of time - Brambles will go up the field fence. This can be seen on one of our railway line fields in Gosberton. We have first hand experience.
- 5 Jo Phillips made the comment that walkers would appreciate the screening. Please see our previous submission and maps which shows that the lane goes directly onto the A16 road and is not safe and therefore not used by Walkers.  
Also as previously submitted there are only a few dwellings which have views in the direction of the proposed substation and as there are numerous mature trees/hedges already adjacent to the 10 metre strip, it seems totally unnecessary to plant anymore trees/scrub/hedges. We have attached an aerial map with the direction of view for the dwelling and the only other Farm in the vicinity, which is a considerable distance away. Please refer to drawing map 46 of 51 to see all the extensive proposed screening adjacent to the A16 road.
- 6 Map 46 shows a large gap in the proposed landscaping strip where access is required for maintenance to the large electricity pylon already located in this field. Under current proposals a further pylon is being considered with the Grimsby to Walpole scheme. This of course will mean a further large access gap required on the landscaping strip !!!

As Farmers we are not opposed to the future of green energy and we must work together to improve the infrastructure. However as we have tried to explain in this letter - wanting to take away our Farmland is very upsetting.

Spalding is just 5 miles up the road and South Lincolnshire road users and walkers have lived with the huge power station on the A16 for many years now without one tree being planted.

Living in the Fens is about open views and productive farming.

We are always happy to meet people on site to prove our point of view.

Yours faithfully,

Cheryl & Tim Smith  
Walter Smith (Gosberton) Ltd.



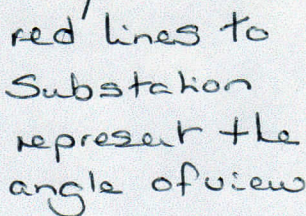

Pyron  
ROUTE



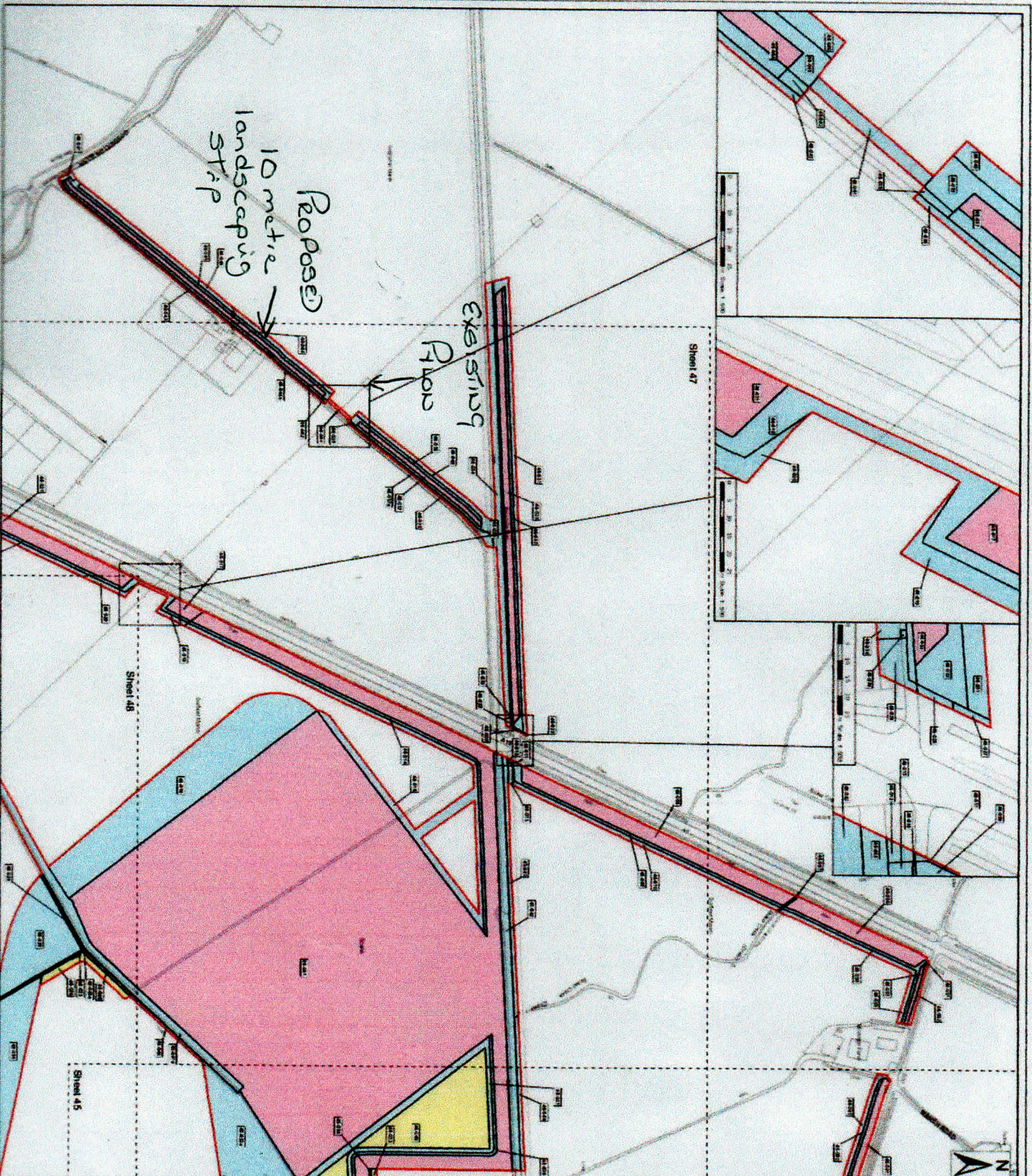

- Legend
- Order Limits
  - Freehold
  - Permanent Rights
  - Temporary Rights

① 240000  
46.

Source:  
Contains Esri Community Maps Contributors, Esri UK, Esri, TomTom, Garmin, Foursquare, GeoTechnology, Inc, HERE/NAVIA, USA, Esri, TomTom, Garmin, Foursquare, GeoTechnology, Inc, HERE/NAVIA, USA.  
Based upon the Ordnance Survey Map with the sanction of the controller of HM Stationery Office. Crown Copyright Reserved. © License No. 0100031673

Ordnance Coordinate System  
Datum: OSGB 1936  
Spheroid: Airy 1830  
Projection: British National Grid  
Central Meridian: 2 W  
Vertical Reference: Mean Sea Level



Drawing No. P91 ODOV DRIVE'S MAP 0005\_02

Drawing: 46 of 51

Rev	Date	Description	By	Check	Appr
1	10/03/2024	Issue for planning	W. Smith	J. Smith	J. Smith
2	10/03/2024	Issue for planning	W. Smith	J. Smith	J. Smith
3	10/03/2024	Issue for planning	W. Smith	J. Smith	J. Smith
4	10/03/2024	Issue for planning	W. Smith	J. Smith	J. Smith
5	10/03/2024	Issue for planning	W. Smith	J. Smith	J. Smith
6	10/03/2024	Issue for planning	W. Smith	J. Smith	J. Smith
7	10/03/2024	Issue for planning	W. Smith	J. Smith	J. Smith
8	10/03/2024	Issue for planning	W. Smith	J. Smith	J. Smith
9	10/03/2024	Issue for planning	W. Smith	J. Smith	J. Smith
10	10/03/2024	Issue for planning	W. Smith	J. Smith	J. Smith

Outer Dowsing Offshore Wind  
2.5 Land Plans V6  
DCO Application



This document may only be used for the purpose for which it was submitted and in accordance with the terms of the agreement for that submission. No other use of this document in any form whatsoever is prohibited.